



McVeigh Parker

XFENCE LIVESTOCK SPECIFICATION SHEET

An unobtrusive smooth surface X knot greatly reduces the risk of fleece removal or hide damage, this is the most common mesh pattern used in the UK, ideal for most types of livestock.

- 24% stronger Knot
- Manufactured to BS EN 10223-5
- Exceeds BS EN 10244 Class A
- Wire produced to BS 4102

Benefits

- Superior alu/zinc coated wire, lasts 3-4 longer than galvanised wire
- 450mm pre-stripped ends more than most
- Premium primary wires only used in Xfence fabricated netting
- Consistent superior high tensile strength wires only
- Greater rigidity due to the one-piece vertical wires
- Smoother and safer non-abrasive forged X knot
- Proven in the field since its conception in 2007
- Easier to install, almost self-supporting
- Save on both labour and posts
- Longer maintenance free life
- Guaranteed to last
- Made in New Zealand by the specialists in high tensile fencing
- Distributed nationally by the UK's leading fencing supplier

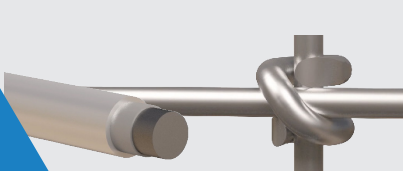

- Manufactured from highest quality primary metals
- 95% Zinc 5% Aluminium
- XTRALIFE coating 24% stronger knot
- Smooth animal friendly abrasive free design forged X knot

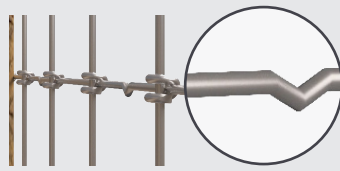

- Tension curves absorb any pressure from climatic change or livestock pressure. Reduce by 50% for visible tensioning
- 450mm Pre-stripped ends, speeds up tying off time

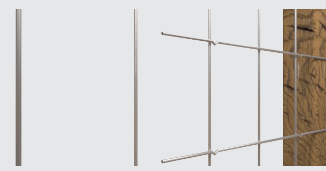

- One piece uncut vertical wire
- Acts like its own intermediate, provides real strength & rigidity to the fence, almost self supporting
- Makes installation quicker

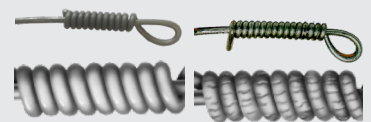

XTRALIFE

Heavy Galv

- Xtralife coating makes the wire more ductile, easier to work
- Resists cracking when tying off, unlike some heavy galvanised wire

Real return on your investment, not all wire is the same, why gamble?

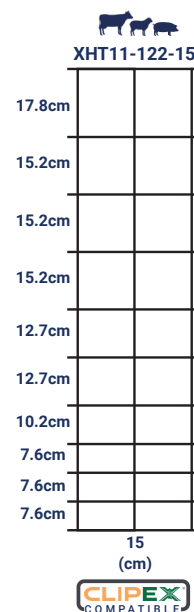

Specification	Horizontal Wires	Vertical Spacings (cm)	Height (cm)	Roll Lengths (m)	Code
XHT6-80-22	6	22	80	100m	F2424
				300m	F2425
XHT8-80-15	8	15	80	100m	F2412
				300m	F2414
XHT8-80-22	8	22	80	100m	F2415
				300m	F2419
				500m	F2422
XHT8-80-30	8	30	80	100m	F2416
				300m	F2418
				500m	F2417
XHT11-122-15	11	15	122	100m	F2405

